

8-27-1975

Arbiter, August 27

Associated Students of Boise State University

Although this file was scanned from the highest-quality microfilm held by Boise State University, it reveals the limitations of the source microfilm. It is possible to perform a text search of much of this material; however, there are sections where the source microfilm was too faint or unreadable to allow for text scanning. For assistance with this collection of student newspapers, please contact Special Collections and Archives at archives@boisestate.edu.

Announcements

AUGUST 27, 1975

BOISE STATE UNIVERSITY

ISSUE 1



Susan Mitchell, dean of residential life, has been selected as Idaho's Outstanding Young Woman.

Mitchell named Idaho's outstanding young woman

Susan Mitchell, Boise State University Director of Student Residential Life, has been named as Idaho's Outstanding Young Woman of America.

Out of nearly 6500 entrants to the contest nation-wide, Susan was chosen as the winner from Idaho. She is now eligible for competition with the other 49 state winners where the top ten young women of the nation will be chosen.

Judging for the top ten winners was held in Washington, D. C. on August 6. Winners will not be notified until November, however, at which time Young Americans Corporation will fly them to Washington, D. C. to be honored at a luncheon and dinner at which time they will be given their awards.

The purpose of the Outstanding Young Women's competition is to honor women between the ages of 21-35 who have distinguished themselves in dedication, service, and leadership in their community as well as their own profession.

Susan Mitchell has been employed with Boise State since 1972. She was Dean of Women until 1973 when she became Director of Student Residential Life; the position she continues to hold. Prior to that, Susan was employed with the Bank of Idaho.

She is thirty years old, married and is the mother of two daughters;

Heather, age 2½ and Kiandra, 7 months. Susan's husband, Dr. John W. Mitchell is also employed at Boise State as an Associate Professor of Economics.

Susan attended the University of Colorado from 1962-66 where she received a Bachelor of Arts in History. She then attended the University of Oregon from 1966 to 1969 earning a Master's Degree - Interdisciplinary Studies and also in Counseling.

While attending the University of Colorado, Susan was the Program Commissioner for the University; Student Senator, Spurs President; Junior Women's Honorary; Mortar Board; Sorority Vice President and Scholarship chairman; a member of the President's Council; Residence Hall president; Honor student; member of various university choruses; and Captain of the Varsity Athletics.

Susan was a graduate scholarship winner - 4.0 GPA for three years at the University of Oregon and a soloist in various choruses.

Susan has been involved in many community activities including: canvassing for American Cancer Society and similar organizations; a member of the Oklahoma cast; a member of Madrigal Club Singing Group-scholarship winner; soloist at various community and university events.

As an honor student, Susan has been named to several Who's Who publications: Students in American Universities and Colleges; Women of the Nation; American Education; American University and College Administration.

Susan also belongs to various pro-

fessional organizations and memberships. National Association of Student Personnel Administrators; American Personnel and Guidance Association; American College Personnel Association and Commission III; American Association of Higher Education; National Association of Women Deans, Administrators, and Counselors; Association of College and University Housing Officers; Northwest College Personnel Association; Personnel Training Committee for ACUHO; Western representative for RSVP, the publication of Commission III.

Beside Susan's professional, community memberships and organizations, she still has time to enjoy her favorite hobbies, music, painting and all sports.

The Outstanding Young Americans organization first published biographical data on Outstanding American Men in 1964 and Women in 1966. The organization is owned by Fuller and Dees, a subsidiary of Times-Mirror, one of the largest publishing companies in the world.

Auditions to be held

The Theatre Arts Department will be holding auditions for their upcoming play, *Country Wife*, by William Wycherly in the Subal Theatre September 3 and 4 from 3-5 p.m. and 7-10 p.m. respectively. For further information call Theatre Arts at 385-3957.

All Theatre Arts productions are open to all students regardless of major.

Vets to be certified from September-May

Veterans at BSU will no longer be certified on a 12 month basis. Effective this fall semester veterans will be certified from the beginning of the semester in September to the end of school in May. Summer school will only be certified for summer school dates.

The following schedule will be adhered to in certifying BSU veterans to receive benefits from the Veterans Administration. (Summer sessions will be certified at a reduced rate.)

1. If the veteran is an undergraduate student, his benefits will be determined by the number of hours he enrolls for according to this schedule: 12 or more semester hours - full time; 9-11 semester hours - 3-4 time; 6-8 semester hours - ½ time; Less than 6 semester hours - Registration fee only.

If the veteran is working on a second undergraduate degree he must have evaluation done by the evaluator in Room A-108. Only then may he be paid for those

courses which are required for his second degree.

2. If the veteran is a graduate student, his benefits will be determined by the number of undergraduate and graduate hours he enrolls for and by his educational objective. Graduate students must be enrolled in a graduate program or obtaining a second degree and can only be paid for the courses which lead to their educational objective.

If a veteran is enrolled in a Masters Program and is required to take undergraduate classes (i.e. prerequisites), he will be paid at the undergraduate rate. All graduate students must have a Program Development form on file in the Graduate Admissions Office, Room A-101.

If all courses for are graduate level (500 or 400G level), the following schedule is used: 9 or more semester hours - full time; 6-8 semester hours - 3-4 time; 4-6 semester hours - ½ time; Less than 4 semester hours - Registration fee only.

Senate report

Summer sessions held

by Helen Christensen

The scholarship parking system, Presidential appointments and the Ray Mittelieder memorial were some topics of business covered during the special summer senate meetings held in June and July.

At the July 31 meeting ASBSU vice president, Ron O'Halloran, stated that the scholarship parking system, whereby any student, staff or faculty member desiring a particular parking space must pay \$30 for that space, is a "far more equitable system because there will be no more free gratis parking for anyone. The students have in effect an open parking system because they can park anywhere they choose if they purchase that space and any spaces not sold by September 22 will be considered open parking for any car with a \$2 decal".

Doug Gochnour, senator from the School of Arts and Sciences, stated "we can't loose with this system. The faculty and staff are now on the same level with the student, nobody has any privileged parking. We all have to pay the same and since \$28 of the \$30 cost goes to scholarships for students, we really can't loose."

ASBSU president, Nate Kim, explained how the system was decided upon. "About the second week of April BSU President Dr. John Barnes stated that since the

students and faculty could not decide on a system that would please both sides, he would personally decide the issue. Barnes took the issue to the State Board and it was passed in July," Kim stated.

Some presidential appointments passed by the senate during the summer included Steve Robertson as head of the Photo Bureau, Nick Casner as Director of Public Relations and Jerry Michaelson as Business Manager.

The senate also accepted a proposal from John Elliott to co-ordinate the BSU Homecoming Book.

Royanne Klein, senator from the

School of Arts and Sciences reported to the senate that Barnes was assuming the cost of the Ray Mittelieder Memorial, a plaque to be placed on the upper deck of the stadium. The memorial should be completed by the first home game, she added.

The senate also approved the allocation of \$200 from the 74-75 scholarship fund to provide a Ray Mittelieder Memorial Scholarship for a student from Meridian High School. The scholarship is a non-recurring expense and will only be allocated this year.

PULSE to be published

After an absence of several years, the BSU Student Union Programs Board has announced that the BSU PULSE will again be printed for circulation on the campus and throughout the community. The PULSE, which is a small publication dealing with the events at the University, which will be edited by SUPB Publicity Chairperson John Elliott.

The new ASBSU publication will see its first edition on October 1 and will be published once a month throughout the school year. According to a SUPB official the

PULSE will help in public relation campaigns and will be a valuable instrument for communicating with the students of this campus as to what events have been scheduled for the upcoming month.

Elliott stated that the PULSE will be entirely interested in entertainment events and Programs Board reports. "We have no interest beyond that."

The Programs Board is considering the feasibility of a contest designed to rename the PULSE. Further information on this project will be forthcoming.

Maybe not this time

Amid charges of repression of free speech and unfair representation, the new Scholarship Parking System has gone into effect. This plan calls for the purchase of \$30 reserved spaces at various close-in lots.

At first glance, the new system seems to be fair to all involved. Upon closer examination however, several inconsistencies arise.

First is the date the reserved spaces went on sale, August 1. Although the plan allows students, faculty and staff to purchase the spaces, the question arises: how many students are on campus August 1? Also, how many students are buying those spaces? Logically, students can't get something they aren't around to buy. This leaves them right back where they started. Little close-in parking.

The second problem involves cost. \$30 is a high price for many students to pay. This \$30, coming on top of fees and books is a little too much for students to handle.

One complaint of the system is the way in which it was initiated. Neither the faculty or the student senates approved the plan before it went to the State Board of Education. Boise State University President Dr. John Barnes took the matter into his own hands after various other groups on campus had difficulty arriving at a solution. Barnes took his plan before the State Board without prior consent of either senate.

Still another question is where the money is going from the sale of the spaces. According to the plan, \$28 of the \$30 will go into a scholarship fund for "academically superior" students. No one has yet defined what an academically superior student is, or whether scholarships will be limited to a specific group of students, i.e., freshmen, etc. And as a pamphlet issues by a group seeking to boycott the plan stated, no student should have to pay for another student's education.

Many potential buyers have also questioned a statement made by the Parking Control Center that the "purchase of a pre-numbered space does not guarantee the space will be available." That is like paying \$30 for a lottery ticket. Maybe the space will be there and maybe it won't.

Enforcement will be by the City Treasurers Office, only this time it won't be \$2.00 tickets. The tickets will be \$10.00 with the possibility of a tow-away after November 15. Another financial question, what will happen to that \$10.00? Will the city keep part of it as in the past, or will it be divided equally with the school? No one seems to be telling.

Parking has long been a problem at Boise State. The new system doesn't seem to be the plan to solve the problems either, at least not with the information that has been issued so far. Perhaps the best way would be to start all over again. Or ban cars from the campus and ride horses. But would the groundskeepers add one more chore to their others?

B.B.

Barnes welcomes students

Editor, the Arbiter

We welcome you to the campus for the Fall of 1975, and to the year of the Bicentennial celebration. It should be an interesting and exciting year in that a variety of exceptional programs will be offered in the Student Union Program Board events, the University Film Series, Bicentennial and historical celebrations; the dedication of the Special Events Center, and, as usual, an exciting sports program for both men and women.

The University has added a number of able faculty members to

its roster and others are added year by year to remember its motto "Developing Academic Excellence".

We urge you to seriously apply your mental abilities to your major field of interest and, wherever possible, to broaden your educational opportunities by involvements in music, the arts, and in helping to manage the student affairs of the University.

Cordially yours,
John B. Barnes
President

Kim lists events

Editor, the Arbiter

I would like to take this opportunity to welcome you back to Boise State University. 1975-76 promises to be an interesting year, more so than just the Bicentennial theme. Growth within our school is all around us. We are looking forward to our enlarged stadium, our new Special Events Center, and construction is now under way for a

new Science Complex. Serious discussion is on a SUB Annex and the State Board of Education has given its approval to start the planning stages for an additional Vo-Tech building. We will also witness growth in extended curriculum programs; examples being: Masters of Public Administration;

Bachelor of Arts in Ethnic Minority Studies, just to name a few.

What the ASBSU has to offer in the areas of Programs are Pop Films, Concerts, including the Beach Boys, America, Edgar Winter, etc.; lectures will start with Moshe Dayan; Student Services office will provide legal consultations, transportation, medical referrals, etc.; and the Public Relations office will sponsor a once-a-week radio program utilizing information and things to do on the campus.

I feel it is necessary that we should also lobby our State Legislators and the State Board of Education more effectively, that we might obtain a lower student-faculty ratio, and that we might show them that we deserve more funds than we are appropriated.

The ASBSU offices are open all day during the week so if you have any questions, suggestions, or just want to talk, please stop by. Mahalo & Aloha,
Nate Kim, President ASBSU

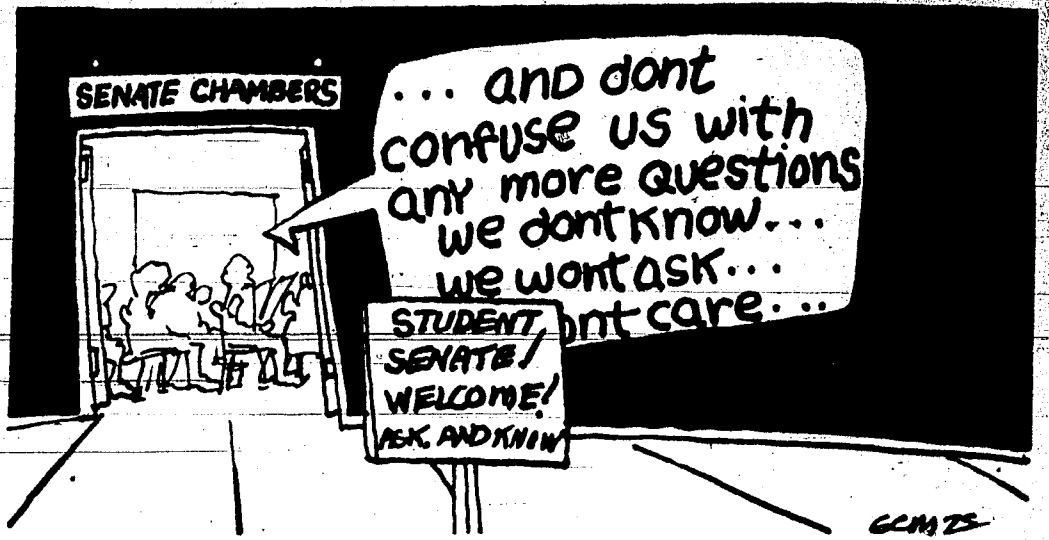

Cannon Fodder

Sunrise over Stonehenge

by Jack Bryson

The sun was just below the peaks of the mountains, and the air was still and cool in the early morning dawn as Boise slept before the rising sun flooded the valley with yet another intense hot August day.

They began to arrive in small groups parking their cars in their official parking places in the stadium lot. Quietly and sleepily they trudged up the ramp and into full view of the striped synthetic

turf. The coolness of the early morning made some of them shiver, but all were awed by the huge concrete structure that stood silently across the field, for the last time they had assembled here the new upper deck of the stadium was still an architects dream.

They assembled in their bright orange seats donning their blue and orange cowboy hats, and those less lordly sat in their respective reserved seats nearby. Many looked about the stadium anticipating the

arrival of the expected, while others tried to shake the chill of the morning air by drinking coffee from their thermoses and some sipped from a brown paper bag to reduce the chill.

The blue door of the varsity center suddenly burst open and out

ran a half dozen cheerleaders from years past. They ran across the field towards the now cheering crowd and took their places. In spite of the early morning hour the crowd responded enthusiastically to the organized cheering. "FIRST IN TEN, DO IT AGAIN! FIRST IN TEN, DO IT AGAIN!" the crowd chanted in unison as if the team was down on the field. "PUSH 'EM BACK, PUSH 'EM BACK, WAY BACK! PUSH 'EM BACK, PUSH 'EM BACK, WAY BACK!" The crowd grew excited swaying to the rhythm of the cheers. "BLOCK THAT PUNT! BLOCK THAT PUNT!" Finally the cheerleaders whipped the crowd into a frenzied shouting. "WE WANT A TOUCH-DOWN! WE WANT A TOUCH-DOWN!"

As the first rays of sunlight crept over the new upper deck the cheerleaders formed a human pyramid in honor of the sunrise at this dedication ceremony. Instinctively, the crowd grew quiet as they watched the unique spectacle of the sun rising over section 16, seat 22. The worshippers looked back over their shoulders and saw the first rays of sunlight reflecting from the press box windows onto the new section, signaling to all that the stadium could now seat more people, and produce more revenue for more scholarships for more football play-

ers and the Broncos could win more football games.

The dedicated follows broke into wild frenzied, uncontrollable shouting. "What a magnificent engineering feat," they screamed. "Now we will always know where the sun will rise, just as our leaders promised. They told us it would rise over section 16, seat 22, and truly it has - tomorrow section 16, seat 23.

Unexpectedly, the door of the press box opened and Coach Tony stepped out into the brilliant sunlight wearing sunglasses. The golden rays of sunlight turned his silver hair into a crown of gold. Frenzied more now than before, the worshippers began leaping and shouting, holding their arms over their heads as if signaling a touch-down. Coach Tony stood silently for a moment, turned around and disappeared back into the press box.

The thundering roar of the modern day Druids melted away and silence once again filled this moment. Slowly the Druids filed out of Stonehenge and into the parking lot. Looking back with awe they felt a new confidence in their leader, for with everyone's money the leaders had constructed a giant solar monument that would assure others that the sun truly rises and sets over Stonehenge stadium.

'Historic view of BSU' presented by Public Relations office

Editor, the Arbiter

The 75-76 school year is upon us and we in the ASBSU Public Relations Department would like to take this opportunity to welcome everyone back to school and extend an open invitation to all Boise State students to get involved in several of the projects the P R office has initiated this year. The following are a few of the projects and the names of some individuals who can give you information on the activities the P R office is involved in.

Starting Sunday, August 31 at 8:44 p.m., the ASBSU Public Relations office will initiate a weekly radio program. The program will be aired on KFXD and give an in-depth view of some aspects of the Boise State University campus. This program will be interesting as well as informative. We are going to say and bring out little known facts about departments and individuals who make this institution function. For information call Mark Hopkins in the Public Relations office at 385-1622. Be sure and listen to this program every Sunday. It ought to be interesting.

Also, this year the P R office is involved in the Bicentennial in a program we refer to as "an Historic

View of BSU". This project will bring out the history of this institution starting with the 72 students who walked through the doors of St. Margaret's Hall on September 6, 1932. We will go through some of the events and people who have made this institution the aggressive young college it is. For information on "an Historic View of BSU" call Steve Peterson in the P R office.

If you would prefer getting involved in more of the social activities, such as pre-game functions,

picnics, contest and sorts of extravaganza, please contact our resident socialite - Gary "Bear" Crist - in the P R office 385-1622.

If any of these programs interest you of if you have any ideas that might benefit the University, please give us a call, or better yet, come in and see us. We're on the second floor of the Student Union Building next to the ASBSU offices.

Remember, it's our University and it's only as good as we want to make it!

Nick Casner, Director
Public Relations, 385-1622

The ARBITER is published weekly by the Associated Students of Boise State University. The offices of the ARBITER are located on the second floor of the Student Union Building, Boise State University, 1910 College Blvd., Boise, Idaho 83725.

typewritten and bear a legible signature.

Editor.....Barb Bridwell
News Ed....Helen Christensen
Bus. Mgr.....Trish Coombs
Ad Mgr.....Mark Hopkins
Sports Ed.....
Reporters.....Nancy Rose
.....Alota Fairchild

Lay-out Ed.....Leah Cothorn
Lay-out Asst....Claire Walker
.....Jean Porter
Photos.....Steve Robertson
Columnist.....Jack Bryson
Staff Asst.....Susan Smith

Articles and letters to the editor must be received prior to 12:00 Noon Thursday before publication. All articles and letters to the editor must be

ATTENTION SPORTS FANS

The Arbiter is in dire need of a sports editor. Must be free to travel to away games. Apply Arbiter office, second floor SUB.



Students and faculty demonstrated their dislike of the new Scholarship Parking plan on the day the spaces went on sale. Among the protestors were (L-R) Clara Perkins, John Hohirin and Kay Wood.

Reserved parking plan stirs controversy

Reserved parking on the Boise State campus will cost \$30 for faculty, staff and students alike this fall as the new Scholarship Parking System goes into effect. The plan is so named because \$28 of the \$30 will go into a scholarship fund for academically superior students. The remaining \$2.00 will go into a parking maintenance fund.

The new system is on a first come first serve basis with reserved spaces being sold in the Administration Building lot; the Library, Business, Liberal Arts-east, Student Union Building and Health Center lots. The spaces went on sale August 1 and will continue on sale until September 22. They are available in the Parking Control Center on the second floor of the Administration building.

Students, Faculty and staff not purchasing a reserved space may park in the Towers lot and on campus streets after the purchase of a \$2.00 decal. Cars may park in the stadium lot without a sticker.

The City Treasurers Office will continue to issue tickets to violators. Initial tickets will be \$10.00 with the possibility of a tow-away after November 15.

Several groups on campus sought to boycott the plan. A group of faculty and staff urged a boycott in a flyer handed out prior to the sale of the spaces. Another group, called the Your Freedom Committee, headed by Dr. Jerry Gephart, said the system abridged the freedoms of the First Amendment.

The pamphlet issued by this group stated, "The faculty and staff of this institution already give beyond the call of duty and should not have to purchase one of the few benefits they have left." It further stated that "No student should have to pay for another student's education."

This group originally put the pamphlets in campus mail boxes, but administration officials had them removed. The committee

also picketed in front of the parking control offices on the first day of the reserved space sale.

Handicapped students, faculty and staff may buy a pre-numbered space for \$2.00 on the advice of their doctor. Motorcycles must park in designated spots and must have a \$2.00 decal.

One of the complaints of the system stems from a statement from the PCC that the purchase of a pre-numbered space does not guarantee that the space will be available. In the event a pre-numbered space has been purchased and a car is parked illegally, the owner of the space may park in an open or non-reserved space without penalty. Reserved spaces are non-transferable if a person terminates employment or student status.

For more information, contact the Parking Control Center on the second floor of the Administration Building.

Women's Alliance meeting slated for Sept. 7

Sexism is a historical, sociological, economic and all pervasive fact. It is impossible to look at any aspect of our culture, family, schools, churches, or media and not find this a dangerous quality. Sexism is dangerous to women, men and society because it deprives women of the opportunity to function as whole and healthy human beings. It deprives men of

ways of behaving and expressing ourselves. Some of the women of BSU have felt a need for a women's center. It is so hard to struggle for wholeness by ourselves. There is strength in numbers. Sunday, September 7, at 7:00 p.m. in the Nez Perce room in the Student Union Building, there will be an organizational meeting of the Women's Alliance of BSU. All

the joy found in partnership between equals, and it deprives society as a whole of the ideas and energy of both men and women locked into crippling sex roles.

It is not enough simply to be aware of sexism. We must examine ourselves, our relationships, and our institutions carefully and work together to become free. We must oppose the more blatant forms of institutional sexism vigorously. We need to find new

interested men and women are encouraged to come. We have a couple of possibilities for a permanent meeting place, and a lot of energy and ideas. Some of the program ideas under discussion are: a woman's self-help health clinic, a women's film festival, an art collective, writing workshops, yoga and massage classes, auto mechanics classes, a library, and consciousness raising groups. Please come and bring your ideas.

Brock honored in book store competition

Betty Brock, Boise State University's Bookstore Manager, recently was honored as a winner in The College Store Journal's Pick-Promote-Profit competition.

The contest which is cosponsored by the Association's Merchandising Committees is nation wide in scope and included printing of Ms Brock's article in the College Store Journal.

"Doing Things Better" titled the article written by Ms. Brock which included two innovative ideas put

to use in BSU's Campus Store. A printed receipt used by students for the express purpose of dropping books that were not needed has been incorporated in the Book Store's policies.

During the rush periods when additional help is needed at the store, Ms Brock has enlisted the help of Retired Senior's Volunteer Program to aid with the checking of student's book bags, parcels, coats and such.

BSU News Bureau

CUSTOM 8-TRACK TAPES

professional quality * satisfaction guaranteed * wide selection

to insure top quality

you choose the music

ONLY THE FINEST EQUIPMENT AND TAPE IS USED.

CHOOSE FROM ALL OF YOUR FAVORITE ARTISTS.

EACH TAPE CONTAINS OVER 64 MINUTES OF MUSIC.

introductory offer

YOU PAY ONLY \$3.88 FOR ANY TAPE. COUPON MUST ACCOMPANY ORDER.

THE TAPEWORKS 345-9524

1/2 OFF ANY TAPE-REGULARLY

NAME

PHONE

limit one per customer

hours

WED. - FRI. 10 AM - 8 PM

SATURDAY 10 AM - 2 PM

CLOSED SUNDAY,

MONDAY,

TUESDAY

the tapeworks

345-9524

Campus Store plans fund raising project

BSU's Campus Store has initiated a new policy that warns students not to buy textbooks until they attend their classes. No refunds will be made on fall textbooks until September 8. Instructors are asked to remind students of the new policy.

According to Betty Brock, Campus Store Manager, "We just don't have the room, we need to use every cash register for 'outgoing' customers and do not have the manpower to handle book returns."

Betty blames increased enrollment but no increase in her floor space for cramped quarters. "We will also have 200 additional charge customers this semester because of increased athletic scholarships."

The Campus Store will also be launching into three innovative programs designed to provide

better service for students, faculty and staff as well.

"I'm excited about our new scholarship fund raising project", said Ms Brock, "this is a pioneer adventure... a first in our area."

A coupon book containing over \$200.00 in values will go on sale only at the Campus Store for \$6.95. According to Ms Brock, \$1.00 of every sale will go toward the student scholarship fund.

Radio KBBK is cosponsoring the project and will provide free advertising to promote the Campus Store coupon book. Values include such things as free dinners at the Spaghetti Warehouse, the Bronco Hut and ticket values at the Vista Theatre.

The Campus Store is sponsoring the "Traveling Book Display", a 44' van loaded with new books for faculty inspection.

The van will give all faculty an opportunity to peruse new book material and discuss problems with knowledgeable people.

This is the first time the van, a product of "College Marketing", will appear in Idaho. It is scheduled to park in front of the Student Union Building, October 8 and 9.

Betty Brock outlined another innovative idea that will be instigated some time in September or October; another first for Boise State University. The Campus Store will stock airline schedules and periodic vacation discounts for the following airlines: American; TWA; United; Western; Delta; National; Braniff; Air West; Continental; Eastern; and Allegheny.

Boise State is one of only 200 selected colleges across the nation who will be allowed to stock these airline schedules.

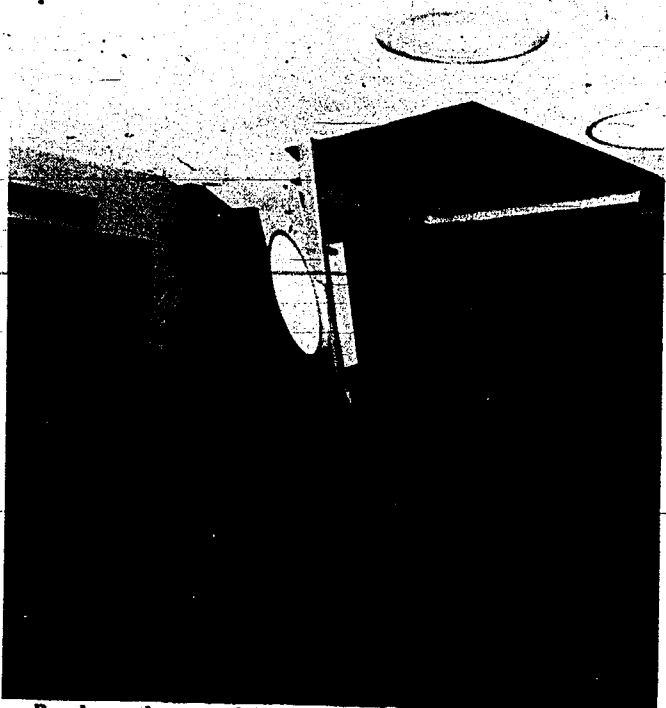

People on the second floor of the Student Union Building were surprised to see the sky falling last week. Two men plumbing the Look Out fell off a board above the false ceiling and fell to the floor amid a shower of plaster. Neither were hurt. As one secretary in the Union said, "What else can you say but 'how nice of you to drop by.'"

Programs board asks for officers list

According to the constitution, all organizations must complete an officers list to be handed in to the Student Union Programs Office, second floor, Student Union Building.

Forms can be obtained from the Programs Office, and should be turned in no later than September 15, 1975.

Any organization unable to fulfill this request by September 15, please notify the Programs Office in writing regarding their delay.

A Senate Chambers Archives will be provided for displaying of copies of organization charters. This will give added recognition for your organization.

Any question regarding the requests, call 385-1223.

We are hoping each organization realizes the importance of this notice, as their recognition on campus shall be officially revoked, if officer lists are not turned in by due date.

State Board rules on Student Services

Student services such as housing, food and student union operations must become self supporting, the State Board of Education decided when they met in Boise in July.

Currently, state funds are used to subsidize these services. This amounts to \$512,000 at Idaho State and \$23,700 at Boise State. The Board also authorized BSU to budget \$127,500 from state monies for 1976-77 to help support student services. School officials said they were in financial difficulties.

This Board move brought sharp

criticism from Boise State faculty senate president Monte Wilson. Wilson said he was appalled to see a university being funded half a million dollars for non-academics, while academic areas go underfunded.

BSU also received a \$50,000 research budget, with an additional \$100,000 in a three year phase-in program. ISU received \$354,000 and the U of I 2.93 million.

The Board authorized Boise State's request to budget for a bachelor's degree in construction

management. It also ok'd BSU's requests for a masters program in public administration, bachelors degrees in radiologic technology and physics, \$541,000 for science equipment and \$50,000 for women's athletics.

On construction, the State Board gave top priority to a 1.4 million science-nursing building at Lewis-Clark State College. The Board also gave top priority to the third phase of the state library building for \$500,000.

Off-campus meal tickets

Prices as low as:

Three meal plans to choose from

It gives you:

The most for your money unlimited seconds, thirds...

More free time no meals to prepare

Continental breakfasts Special diets

For information call: housing-385-1228 food service-385-1225

breakfast \$0.63
lunch \$1.10
dinner \$1.42

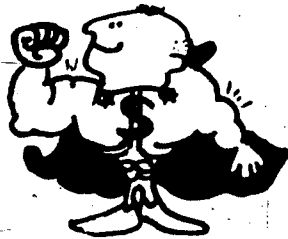

MOLENAAR'S HAS BEAUTIFUL THINGS FOR BEAUTIFUL PEOPLE!

Shop where terms are convenient, atmosphere pleasant and your patronage appreciated...

GIVE US A TRY AT "THE DREAM COME TRUE STORE"

Molenaar's Jewelry of Quality
Jewelers

TWO LOCATIONS

• 1207 BROADWAY • FRANKLIN SHOPPING CENTER

3 good reasons for BSU students to bank at CSB.

• Free Checking

No monthly service charge
No minimum balance required

• Saturday Drive-In Banking

CSB's Drive-in windows are open Saturdays from 10 a.m. until 2 p.m.

• Convenience

CSB's Broadway office is within easy walking distance of the BSU campus



COMMERCIAL state bank

Broadway Office • 1101 Broadway • Member F.D.I.C.



Scholarship money was raised during the "Old and Antique, New and Unique" fair held at Boise State.

Scholarship fund raising held

On June 20 and 21, the Boise State University Student Union Programs Board sponsored the first in a series of events designed to raise \$76,000 for academic scholarships. The event, which was titled New and Unique; Old and Antique,

was held in the Student Union Building and featured merchandise and services ranging from the finest in antiques to bathroom fixtures and handicrafts.

Along with the marketing of area dealer's merchandise, a gigantic plant fair accompanied the event. 4500 tropical house plants shipped to the university from Florida were displayed in the Ballroom. This

part of the show was sponsored by the SUPB in conjunction with the Chicago firm of Holly, Wood and Vine.

The plants that remained after the fair's termination were sold by members of the Programs Board and distributed among the various campus departments and offices as a donation to the university.

SUPB members involved in the event included Bob Hoppie, SUPB Chairperson; Randy Birkinbine, SUPB Lectures Chairperson; Roger Brown and Gary Crist, Special Events co-Chairpersons; John Elliott, Public Relations Chairperson; and Mike Riddlemoser, Public Relations committee member.

Additional honors classes scheduled

BSU's Honor Program is adding to its curriculum again this fall. Humanities 297 - Culture In Context and Honors English Composition are two innovative courses scheduled to draw honor students this fall.

In addition, Radical Economics - EC 497 which was offered last year and two Honors History courses HY-201 and HY-251 will be on the Honors program again this fall. Several seminars will be again offered in the fall semester, subjects to be announced.

Culture In Context is a course organized around fifteen symposia dealing with six cultural periods: the Middle Ages, Renaissance, Enlightenment, the Victorian era, Colonial America, and contemporary America.

Veteran's clerk to curtail calls and inquiries

Starting in the fall after classes begin, it will be necessary for the veterans' clerk, housed in the Registrar's Office, to curtail telephone and personal inquiries from 1:00 p.m. until 5:00 p.m. during the class week.

These changes are necessary because of increased requirements from the Veterans Administration and also because of increased enrollment of veterans utilizing their benefits.

The weekly meetings will be held in the evenings and will be based on guided student research into the various aspects of the period under study. Each class meeting will begin with a representative of the period under consideration, discussion characterized by free exchange of information, ideas, reactions and perceptions will follow.

Jim Hadden and Stu Evett will instruct the course as an experiment in methodology. This course is designed to alleviate the problem

of introducing cultural ideas into an alien environment. The symposia format should result in an academic setting more human, civilized, and concrete than afforded by the normal classroom.

Honors English Composition is being offered for the first time to give students who would ordinarily be qualified to bypass English Composition a second choice in their English requirements.

Radical Economics - EC 497 directly challenges the conventional wisdom of orthodox economics. This course will explore and evaluate radical political economics, its past, its analysis of the present, and its vision of the future. Radical political economics dares to approach the fundamental and important problems of modern society.

Bill Eastlake, Assistant Professor of Economics, will instruct the course on Tuesday and Thursday, 10:40 a.m. - 11:55 a.m., Room B 217.

It is stressed that the Office of Veterans Affairs and the Vet-Rep on campus will have offices open

for service during the regular 8:00 a.m. to 5:00 p.m. Monday through Friday.

New grants available

New federal-state grants of up to \$1,500 a year are now available for Idaho college students. Milton Small, executive director of the

Office of the State Board of Education said the grants may be used for tuitions, fees, room and board,

books or other expenses. Any student enrolled in an eligible school is eligible, providing the student can show definite financial need, Small stated. Application forms are available in the financial aids office in the Administration building.

JOIN Bank of Idaho's Popular BANKING SERVICE FOR COLLEGE STUDENTS



ZODIAC

When you join Campus Club you get free fully personalized special checks (you usually have to pay for them) in a checkbook specially designed for your college or university. With no service charge!

AND THERE'S MORE! You get a \$5000 life insurance policy which you may convert to any type of permanent life insurance at age 22 to 26 regardless of your occupation or health at that time. You get a 50% discount on a safe deposit box, preferential interest rates on installment loans and free financial consultation on budgeting, savings planning or help with any financial problem. All this for \$2.50 per month. It's the biggest bargain in modern banking!

**COLLEGE STUDENTS!
COME TO ANY
BANK OF IDAHO BRANCH
AND GET A
FREE PERSONALIZED
ZODIAC KEY CHAIN**

YOUR PROGRESSIVE NATIONAL



SERVING IDAHO WITH 34 OFFICES
AFFILIATED WITH WESTERN BANCORPORATION
MEMBER F.D.I.C. • MEMBER FEDERAL RESERVE SYSTEM
BANKAMERICA SERVICE CORPORATION 1968
*SERVICE MARKS OWNED BY BANKAMERICA CORPORATION
BANK OF IDAHO N.A.

Gift And Jewelry Items

Special Order Any Book

Campus Clothing

Sundries

Greeting Cards

Stationery

Candy, Cigarettes
And Snacks

And Of Course
Your Textbooks

Art Supplies

Class Rings

Check Cashing
Service

Used Book Buyback
During Finals

Photo Service

Key Making

Xerox Copies

Plastic Laminating

Engineering Supplies

Magazine Subscriptions
(50% Student Discounts)

Cap And Gown Rentals

"To Serve Your Every Need"

**THE BEST QUALITY
at THE BEST PRICE**

Books On Every Topic

School And Offices Supplies

Paperback Department

HEWLETT-PACKARD CALCULATORS

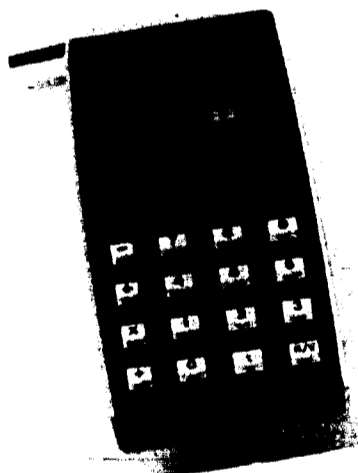

HP-25

you appreciate the
precision and accuracy of fine
instruments, you'll appreciate
the solid design & precision
construction of the HP-25.

\$196.00

P-70
Gives today's
businessmen the
calculation power
he needs at a
price he can
easily afford

\$165.00

P-80
May be the
most revolutionary
financial device
of our time \$295.00

P-55
Takes repetition out
of repetitive problems
\$395.00

HP-65
The small miracle
fully programmed
pocket calculator.
\$795.00

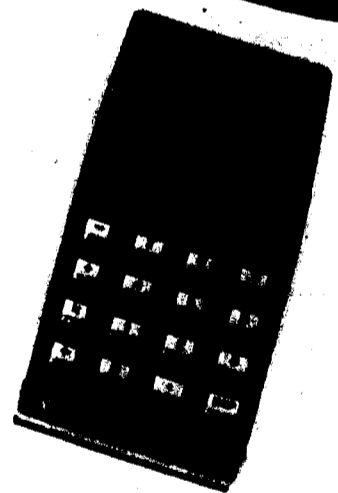

HP-21

All the features and
functions you'd expect in a full
scientific calculator plus
a few surprises!

\$125.00

**AVAILABLE AT
YOUR CAMPUS STORE**

Roving Reporter probes parking

Transcendental meditation lecture set for August 27

What is your opinion of the new parking plan at BSU and do you have any helpful ideas for the project?



Mike Thompson (senior) "I think the whole thing is a farce. We spend enough time and money paying for education without paying for parking. There are enough scholarships available now without students paying into another fund. The administration keeps giving more excuses for more money and students can't afford it. I think the student government ought to get off their butts and exert a little pressure. Student government is not a popularity contest. If they're not doing their job they should be removed."



Sylvia Hansen (Parking Operator) "I don't like the parking plan at BSU and I think it's unfair. Actually, I'm quitting my job as meter person and becoming a student. I don't want to be the one giving out the parking tickets. The faculty and the other parking officials don't like the plan but they'll be the ones getting yelled at, but it's their job and they have to do it."



Dave Anderson (senior) "Basically, I think the faculty should be able to park near their classes. How can they teach if they're late. I'm paying them to teach me."



Rick Weiss (junior) "My point of view stems from experience. I went to a large school and it was a privilege to be able to have a parking place near the adjacent buildings. The other parking places were a half an hour away from your classes. However, there is more plus than minus because we do need more scholarships."



Don Erickson (sophomore) "Sounds like a bunch of bull shit. I don't know any student who can afford it. I can't afford it. The school is just as greedy as everyone else. If you're late for class you're going to park where you can find a place no matter what."



Juli Scholtn (senior) "I think it was handled very poorly."

It was maneuvered in a way to limit equal opportunity for all the students."



P. Virginia Pepple (freshman) "It stinks. I'm not going to buy a sticker. I'd rather park a mile away than buy a sticker."



Steve Wallace (sophomore) "I don't think the city should have any jurisdiction on campus. You don't come to school for harassment."

Although there have been countless attempts to improve the quality of education, the billions of dollars spent in the last twenty five years by private foundations and public agencies appear to leave a great many teachers and students unfulfilled. What education is really asking is, "What should be the objectives of human activity?" If we take the common sense position that the main objective of any activity is to promote the fulfillment of the individuals involved, then the real goal of education would be nothing less than the fulfillment of the student. In the sense we are using it here, fulfillment implies the use of all potentialities or growth latent in the individual. Therefore, the purpose of any educational system is first, to supply a vision of the range of these potentialities and secondly, to effectively provide the student with a practical means for achieving such full development.

The concept of Creative Intelligence arises from an examination of the structure of purposeful change in nature. No matter where we look whether it be in astronomy or biology - or even in the growth of a rose - we observe an orderly progression which indicates intelligence. The intelligence displayed by nature in this process may be called Creative Intelligence, or CI. CI not only exists in nature but is expressed in man in his progressive thoughts and actions. The Science of Creative Intelligence, or SCI,

provides a means of contacting the source of creativity within each individual and bringing this creativity, energy and intelligence into daily activity. The result is fulfillment, full expression of the creative intelligence inherent in an individual's nature. Lack of fulfillment, in this view, is some restriction of the flow of CI from its source at the core of ones being to the level of conscious awareness from which one perceives and acts. This brings about the possibility that human problems can be attacked at a common fundamental level without specific regard to the nature of the problem - much in the same way that a gardener attends to all deficiencies in the plant by simply watering the root.

The simple, natural technique of Transcendental Meditation, or TM, lends a substantial basis to the above considerations. MMY, founder of TM and SCI defines TM as a systematic procedure of "turning the attention inwards towards the subtler levels of a thought until the mind transcends the experience of the subtlest state of the thought and arrives at the source of the thought. This expands the conscious mind and at the same time brings it in contact with the creative intelligence that gives rise to every thought."

There will be a special introductory lecture on August 27 at 7:30 p.m. in the Rodeway Conference Room, 702. Admission is free.

Dorm-ARA Picnic
Sept. 1 Labor Day
 11:00 a.m. on the lawn by the SUB
 free for students with meal ticket
 \$2.00 for all others

THINK SPAGETTI



OPEN SUNDAYS
 the spaghetti warehouse

Open THUR 5:30 pm - 10 pm FRI & SAT 5:30 pm - 11 pm
 16th and GROVE 336-1561



PICTURED: XELMS SHARON DAVIS AND TOM SCOTT IN LEVI'S COORDINATED OUTFITS

Levi's for Guys and Gals

The County Seat handles everything in Levi's for everyone. Blue Jeans, Saddleman Boot Jeans, Gentleman Jeans, Brushed Denims, Cords, Levi's Shirts, Jackets, Levi's 501's, T-Shirts, Miller Belts, Kennington Shirts, Levi's Blouses, Pants and Tops for

Gals; and the complete Levi's Panatella Collection of Leisure Suits and Slacks...

Boise's newest, funkier place for clothes...

Open Monday through Saturday, 9:00 a.m. to 9:30 p.m. Across from the Westgate Mall on Fairview.



Intercollegiate debate team notes start

Mr. James Riley, new BSU Director of Forensics, has scheduled an official start to 75-76 debate activities for Tuesday, September 2 at 3:00 p.m. in Science 217, with all students interested in joining the award-winning squad welcome.

This debate season, Riley stated, the squad will compete with almost every college and university in the western half of the United States. The tournament schedule includes trips to Washington, Oregon, Montana, Utah, Arizona, Colorado, Wyoming, California, Nevada, New Mexico and Texas during the season which runs from September through April.

The intercollegiate competition is sanctioned by the American Forensic Association, and can be taken for BSU credit through the Communication Department. Students can also join the BSU chapter of Pi Kappa Delta, the nation's largest forensic fraternity.

Riley noted that "Forensics can provide unique opportunities for personal achievement, intellectual challenge, and for improving speaking, research, analysis, and organizational skills." He also emphasized that this year's topic is especially timely and controversial.

This year's national debate topic is: "That the federal government should adopt a comprehensive program to control land use in the United States."

In addition to the active schedule of tournament competition, the forensic group will sponsor programs and presentations on campus and in the Boise community. A strong individual events program which can include students not necessarily interested in debate, will feature practice and competition in oratory, oral interpretation of literature, extemporaneous speaking, and expository speaking.



Steve Symms

Food stamps

Symms favors student ban

by Barb Bridwell

A bill currently in Congress could have far ranging effects on students at Boise State receiving food stamps. The bill, House Resolution 7887, deals with the certification process of those requesting food stamps. Representative Steve Symms of Idaho is offering a string of amendments which would bar all students from receiving food stamps. This would include students from poor families and welfare mothers who are attending school.

According to an official at the Department of Health and Welfare, there are approximately 200 students in the Boise area currently receiving food stamps.

Symms stated that he was personally opposed to having students who are able bodied and healthy eligible for food stamps. There are 15 thousand students in Santa Clara County, California (Stanford) on food stamps, according to Symms. "This is really not what was originally intended by the food stamp act."

The Food Stamp Act was originally passed in 1963, with the intention of helping the needy. College students are classified as non-needy, according to Symms. "He is volunteering to put himself in a lesser income role while he gains an education, by choice, so that hopefully, later on he will be in a position to do some profession that he chooses or else he will be in a higher earning potential. If you

volunteer to be poor by going to college you should not be eligible for food stamps," Symms said.

Symms stated that the Food Stamp program has gone from 200 million dollars to six billion, with a 14 thousand per cent increase in a ten year period. It is estimated that one out of every four Americans is eligible for food stamps.

The average middle class American is getting tired of scrimping according to Symms, and then going to the grocery store and "seeing some big, healthy college student paying for groceries with food stamps." This is not the intention of the program, he stated.

In February of 1973, 85 per cent of all food stamp recipients in Champaign County Illinois (University of Illinois) were students. "This is the kind of thing that shouldn't be allowed to continue," Symms stated, "I am going to do anything I can to stop it. This means that there would be a few students at Boise State, that if I had my way, would be taken off them."

Symms says he has no objection to certain students, such as disabled veterans going to school receiving food stamps. "The student makes the choice. Either go to college or go to work. They could work and then they wouldn't have to be on food stamps. We get tricked into believing that going to college is a right."

Symms stated that the amendment will cause "fire works" on the House floor when it comes up for debate. "College students are a highly intelligent group of people. They also are intelligent enough to know how to beat a government program. That is why at Stanford University,

where there is a large percentage of highly intelligent students, they are beating the food stamp program."

There are not too many students at Stanford, according to Symms, who can't afford to be there. "It's a game for a lot of them. They do it for the heck of it. A lot of their parents don't even know they are on food stamps."

Food stamps are used in place of money for many people, according to Symms. He gave an example of a group of school students from a poorer section of Washington D.C., who toured the currency mint in Washington.

"They went up there and saw the twenty dollar bills being printed and they weren't impressed at all. As soon as they got to where the food stamps were being printed, they just went bananas. I think this says something."

Symms said food stamps are viewed as a fiat currency. "We just can't keep it up. What are we going to do when we get everybody on food stamps. The program, as far as helping those really needy, is destroyed."

"I suppose you could make a case for somebody to be in college and have children and have all kinds of extenuating circumstances that I'd even be in favor of allowing on the program."

Once exceptions are made, however, Symms said, there is no clarity to the program. "I don't think it's healthy to have people going to college frauding the public. These people going to college are going to be the government and society leaders. And it's really against the beliefs of the founding fathers anyway."

'Sting' to open series

The award winning motion picture "The Sting" will open the 1975-76 Pop Films calendar on September 14 at 8:00 p.m. in the BSU Student Union Ballroom.

"The Sting" was chosen as Best Movie of the Year in 1973 and stars two top American superstars-Robert Redford and Paul Newman.

Other movies to be aired during the semester include "Dark Star Candy," "Sometimes a Great Notion," "Dumbo," and a Beatle Extravaganza which will include the three famous Beatle movies "Hard Days Night," "Help," and "Let It Be."

All films are free to BSU students.

Arbiter Staff Positions

Be in the know!
Hear exciting scandal
before it happens!

Sports editor, staff writers, circulation.

Apply Arbiter - SUB

What can you do
in a darkroom?

Apply for the
Photo Bureau

Applications are available

in the ASB offices
Deadline: Sept. 13

Heads of committees chosen for board

The new members of the Student Union Programs Board for the 1975-76 year have been selected, and according to Bob Hopple, SUPB Chairperson, are looking forward to the best year ever.

The new chairpersons include Randy Birkinbine, lectures; Eric Bishoff, pop concerts; Lee Moerles, special events; Roger Brown, homecoming; John Elliott, publicity; Pete Parcels, foreign films; Mark Allen, pop films; and Kim

Kirk, coffeehouse.

"Many of the new chairpersons are returning from last year having served on various committees, so they know what's going on and what to do to make sure all events and functions come off as smoothly as possible," Hopple stated.

Many of the committees still have vacancies. If you are interested in working on one of the committees contact the Programs Board in the Student Union Building, or call 385-1224.

Property to be used for office space

Recent property acquisitions by Boise State University will be utilized this fall semester for faculty offices and laboratories.

These acquisitions include eight buildings and properties located within the twelve block area designated by the State Board of Education as the first priority of purchase.

The Bellevue apartments,

formerly used for married student housing, will be used by the Mathematics Department beginning fall semester. They are located directly across from the Student Union building.

Early occupancy of the newly acquired properties has been postponed due to certain legal requirements by the Planning and Zoning Commission. Plans are

being made to occupy the spaces as soon as possible.

Occupants of the new areas include: Archaeology, Music Studios and Teaching Stations, and various other faculty offices on Vermont Street; SEPARS Personnel, Department of Education Faculty, Faculty offices on Michigan Street; Ceramics and Photo Lab on Belmont Street; and Geology Faculty on Lincoln Street.

Vo-tech teachers join in program

Vocational Technical teachers throughout Idaho are participating in a Directed Work Experience Program coordinated through Idaho State University's Department of Education.

Intermountain Gas in conjunction with Boise State University placed Ms Sandy Wood, an Office Occupations Instructor at Prairie High School in Cottonwood, Idaho in this work experience program.

Ms Wood has been in Boise at the General Offices of Intermountain Gas to promote cooperation between business and education and to upgrade her skills through ob-

servance and participation in business with specific attention to current trends.

This program places Vo-Tech teachers in a work study situation

for four weeks. The object of this program is to improve occupational competency and promote school-

business-industry cooperation in the education of vocational and technical teachers.

As a Vo-Tech instructor at Cottonwood, Ms Wood teaches Typing I and II and Office Practice. Sandy is

originally from Kuna, Idaho. Her plans are to continue teaching at Prairie High School in Cottonwood.

Boise Gallery of Art to hold arts festival

The Boise Gallery of Art will hold its twenty-first annual Arts and Crafts Festival September 5-7 at Julia Davis Park. The festival has adopted a Bicentennial theme and will have old-time music and crafts.

There are thirteen different categories, including painting, batik and textile prints, ceramic-pottery, ceramic-china, glass, jewelry and precious metals, creative stitchery

and needlework, lapidary, metal working, mosaic, weaving, wood working and carving and graphic arts.

Exhibitors will be required to pay a \$15.00 fee, with the Boise Gallery of Art retaining a 20 per cent commission from all sales. Each exhibitor will be allowed a maximum of 200 feet fronting the main pedestrian area.



The ground breaking for the new Science-Education building was held in July. The construction is expected to be complete the early part of 1978.

Judiciary reports four openings

There are four openings on the ASBSU Judiciary, according to John Flenelling, board member. Applicants must be full time students (8 credit hours or more) and have a minimum 2.00 GPA. A selection committee meeting for

judiciary applicants will be held September 9 at 2:00 p.m. in the Caribou Room of the SUB.

Applications may be obtained in the ASB office in the SUB and must be returned by September 5.

Your Sound
World
Headquarters

TEAM ELECTRONICS

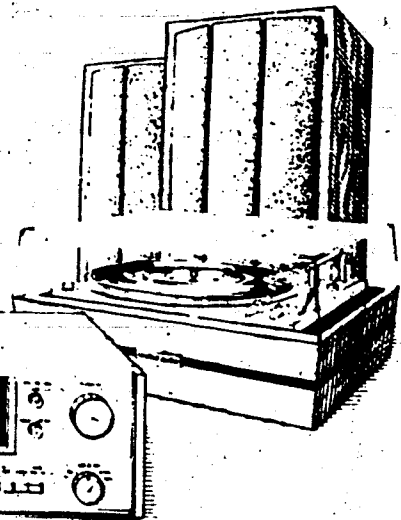

component

- *Bose
- *Pioneer
- *Marantz
- *Altec
- *JBL
- *McIntosh
- *Harmon-Caroon
- *Crown
- *BGW
- *Sherwood
- *Stanton
- *Shure
- *Sony
- *Teac
- *Revov

car stereo

cb radio

Stereo

&

Quad

- *Johnson
- *Hygain
- *Cobra
- *Pace
- *Xtal

- *Pioneer
- *Craig
- *J.V.C.
- *Muntz

TEAM

710 N. Orchard-Boise

*Technics by Panasonic

Subal Theatre announces 1975-76 season

Now that summer is over and another fall semester is here, BSU's Theatre Arts Department looks back at their accomplishments this summer and forward to some new changes.

Ms Delores Ringer has been appointed guest designer for the 1975-76 academic year. She is an MFA candidate from Pennsylvania State University and has served as scenic and costume designer for the Utah Shakespeare Festival at Cedar City for several summer seasons. Ms Ringer will teach a special topics course in costume construction this fall.

Mr. Roger Bedard will be on leave during 1975-76 to begin work on his Ph D at the University of Kansas. He plans to do research in

children's theatre and creative dramatics.

Mr. Del Corbett, associate director of the Subal Theatre, has extended his academic leave for one more year to work on a Ph D in theatre at the University of Oregon.

Mr. Larry West has been retained for another year as guest director and co-ordinator for the Idaho Invitational Theatre Arts Festival. This summer Mr. West directed *Butley* for the Intelist Theatre.

Dr. Robert Ericson, department chairman, attended a June meeting of the Idaho Alliance for Art Education held in Gooding. Dr. Ericson will co-ordinate a special class in drama this fall in conjunction with KAIT, Channel 4. The course is entitled *Classic Theatre - The*

Humanities in Drama and may be taken for university credit.

In cooperation with Mr. William Taylor of the music department, Dr. Charles E. Lauterbach served as stage director for this summer's musical, *Fanny*.

The 1975-76 Subal Theatre season has been tentatively set and will be officially announced in early September. At present the season is as follows: *The Country Wife* by William Wycherly; *One Flew Over the Cuckoo's Nest* (stage adaption of the Ken Kesey novel); *America Laughs* (a bicentennial celebration of America humor in reader's theatre form); musical comedy in conjunction with the Department of Music (title not yet selected); and *The Madwoman of Chailot* by Jean Giraudoux.



Former Israeli defense minister Moshe Dayan is scheduled as the first speaker in the 1975-76 lecture series.

Theatre Arts offers new courses

This semester the Department of Theatre Arts will offer two special topics courses and three special interest courses in addition to its regular curriculum. *Costume Construction and Stage Dialects* are new special topics courses. The costume class taught at 10:40 a.m. MWF by Delores Ringer deals with aspects of construction from pattern to finished garment. Dr. Shankweiler's course in stage dialects will be offered on Tuesdays and Thursdays at 9:15 a.m.

Both the popular courses in film and television will be taught again this fall. Dr. Ericson will teach TA 220: *Cinema - History and Aesthetics*. A former special topics course, *Television Entertainment Then and Now* has become a regular offering of the theatre department called TA 230: *Television - History and Aesthetics*.

The Theatre Arts Department in conjunction with station KAIT, Channel 4, will offer a three credit

course which combines classroom work with the telecasts of distinguished plays from the British Broadcasting Company. The course, supervised by Dr. Robert Ericson, is entitled *Classic Theatre The Humanities in Drama*. Among the plays to be seen and discussed are *Macbeth*, *The Rivals*, *Playboy of the Western World*, and *She Stoops to Conquer*.

For further information on course offerings in the Department of Theatre Arts call 385-3957.

'Sleeping Beauty' is for hard core, soul fans

by Aleta Fairchild

Only the hard-core soul aficionado would want to buy Lenny Williams' *Sleeping Beauty*. Williams has not impressed me in or out of Tower of Power. (He was their lead singer.) This is the kind of album that you can't remember listening to ten minutes after you've heard it. Though the music and lyrics are all written by Mr. Williams himself, there is no uniqueness or originality here. The album contains the characteristic soul beat, and hence, makes good dance music. But with all the new albums coming out these days, I'm sure it would be little trouble finding a better one. The best cut off this album is *Sons of Thieves*,

etc. Buy the 45 and skip the album if you want to get the most music for your money.

Pure Pleasure by the Dynamic Superiors would be more aptly titled *Pure Hype* by the Monotonous Inferiors. It is in the same category as the aforementioned album except there are more guys on it. Notable cut from this album is the title cut. *Pleasure*. Again, buy the single.

'Meddle' is rock classic

by Aleta Fairchild

In 1971, four British musicians recorded an album that has had an impact on everyone who hears it. This album is still available now, but is dwindling slowly away from the music marketplace. Like *Led Zeppelin II* or *Blind Faith*, *Meddle*, by Pink Floyd, is becoming an erstwhile rock classic.

The principal cut on this album (all of side II) is called *Echors*. The

middle to last part of that song is a surreal masterpiece.

I would like to see this song put through the college cafeteria sound system and turned up to the max. It would be a lot harder to go back to the Top 40 after that.

'Traffic' heads list of films

The Foreign Films Committee has finalized their list of films to be shown the first semester, according to chairman Pete Parcells. All films are held in room 106 of the Liberal Arts Building at 7:30 p.m.

The dates and names of the films are:

- September 5, *Traffic*
- Sept. 12, *Scenes from a Marriage*
- Sept. 19, *The Blue Angel*
- Sept. 26, *King of Hearts*
- Oct. 3, *Threepenny Opera*
- Oct. 10, *Shop on Main Street*
- Oct. 17, *Fellini Satyricon*
- Oct. 31, *M & Noferatu*

a silent version of *Dracula*.

Other films to be aired are *Lucia*, on November 7; *November 14, Joe Hill*; *November 21, The Pearl*; *December 5, Hearts and Minds*; *December 12, Rashomon*; and *December 19, Beauty and the Beast*.

BOOK BAG

Heavy duty waterproof Cordura Nylon. Perfect for day packing, hiking, and bicycling

ALSO GOOD FOR BOOKS

UNBEATABLE AT \$12.00 Exclusively at Sawtooth

For backpacking climbing cross country skiing see

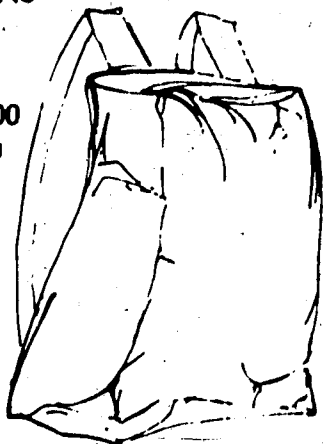

Sawtooth Mountaineering 5200 Fairview Ave., Boise, Idaho

When you look to the mountains look to the leaders

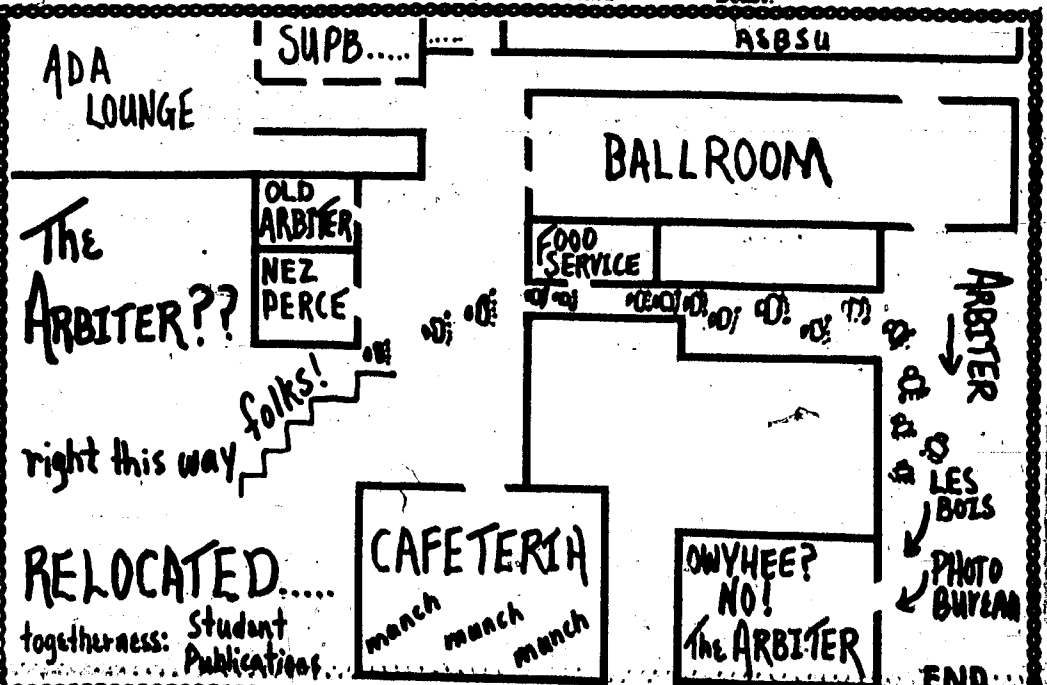

BSU Fall Fashion Preview

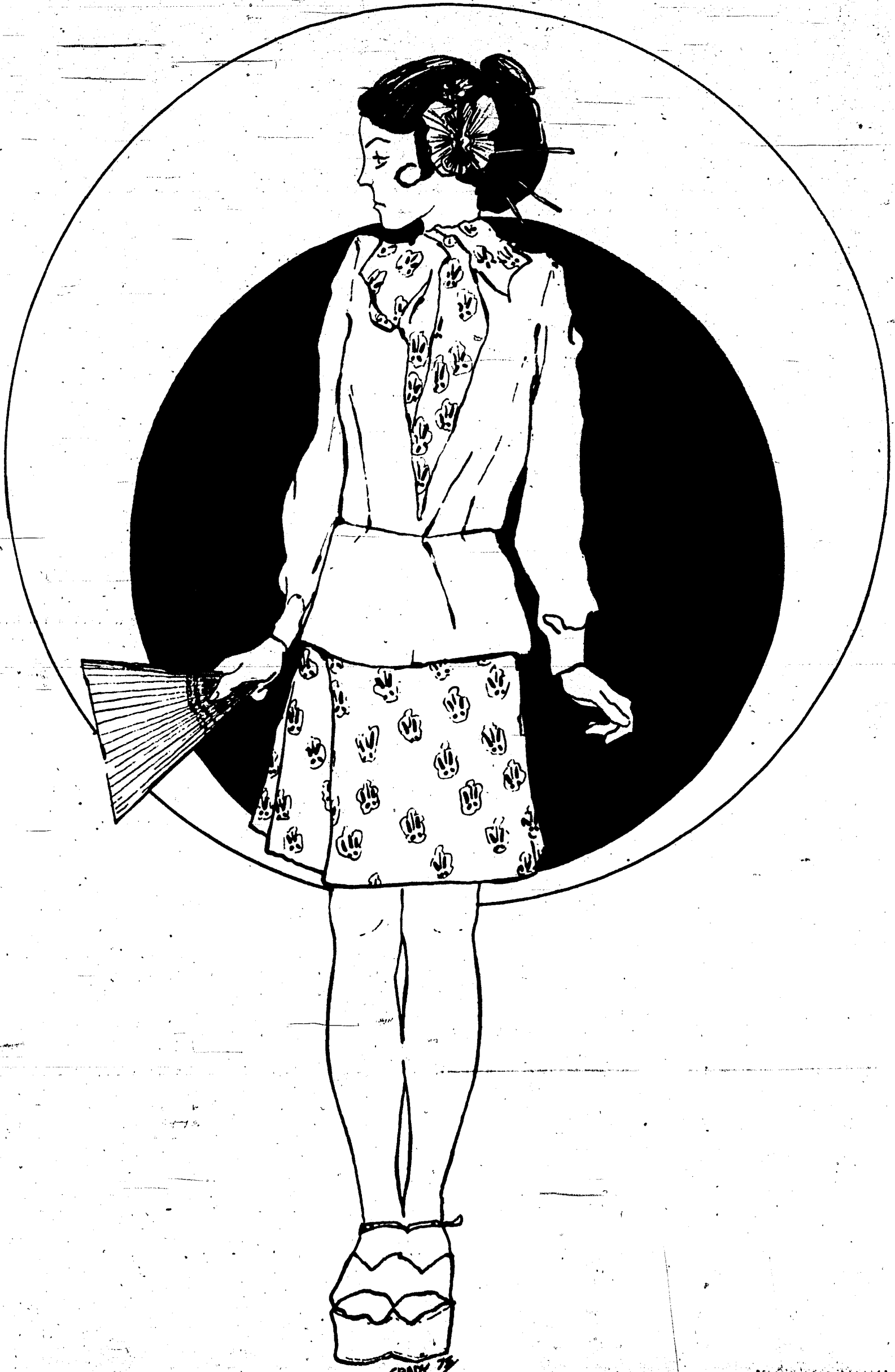

GRADY '79



Riley's
★

801 BANNOCK ST.

Mr. Bronco, Riley's Doug Jones, models patchwork denim pants by Branded Lion Sportswear with an Enro silky print shirt and a leather and suede reversible jacket by Remy Leather, Louann Caster is wearing European fit slacks by Hagger Body Work and a print shirt by Saturdays of California....all available from a great collection at Riley's.



Check the Bon for "The Sweater Story" as illustrated by BSU's Becky Guthrie and Karen Nicley. Becky models Artec's multi-colored block print and Karen tries out a hooded sweater by Bobby Brooks and Collage, from an assortment of sweater sets at the Junior Place in the Bon Marche, downtown Boise and Karcher Mall.

THE BON MARCHE 918 Idaho St



The Tobias collection is modeled by Ric Gale in a texturized dacron Levi's suit by Tobias and a patterned shirt chosen from Alexander's large selection. Kelley Stohr tries out Levi's cords with a Rugby shirt and an Imitation Sheep Levi cord coat.

ALEXANDER'S



Brookover's back-to-school fashions include Ditto polyester and cotton saddle pant jeans, \$15.50, with a short, snapped battle jacket in crinkle fabric, \$15, and a floral t-shirt as modeled by Christie Kenyon. Becky Barnes wears a 25 inch cotton wrap skirt, \$14, with a 3/4 sleeve belted over-blouse, \$14. Both skirt and shirt are braided trimmed. Sandy Brewer is wearing a rust color three piece crinkle skirt set, \$30, that includes a tube top and short tie jacket.

brookover's

Junior & Career Shop
Downtown & Vista Village



Carroll's and corduroy kick off fall in lots of schoolbound ways. Take it quilted and show fall's big trend - the Chinese influence in jacket and skirt, modeled by Bonnie Farr. Or dress it up in a one piece dress with braided rope belt worn by Melanie Kaiser. BSU's Susan Smith tops off corduroy pants with the big top look in sweaters....from a collection of great looks to get around in at all six Carroll's.

Carroll's



MacArthur Park's Bernadette Wanders and Less Johnston show off the new fall looks in jackets and pants. [left] Bernadette models a rust color genuine leather coat from Gussy Jack of North American Leather designed by Gabriel Levy. Les is wearing the Male Jacket, navy blue with red trim. [below] Pants and shirts for back-to-school include Bernadette's Body English pants and a patch-work shirt by bim-bom-bay from India. Les models h.i.s. cords with a contrasting rope insert and an Impact floral print shirt.



MEN'S WARDROBE

713 Idaho St.
Dawn Town Boise

ASBSU V.P. Ron O'Halloran models the casual look in men's wear with a tan corduroy Levis shirt and matching Levis bell-bottom cords. Accessories include a contrasting lace edged Levis leather belt and thick, crepe soled Buzzard boots by Weyenberg. Greg Pitman of Men's Wardrobe wears the new Swedish knit suit by Curlee, a 417 Van Hoesen tapered shirt and Weyenberg message shoes.



Mac Arthur Park

Linda Vista Plaza

[Fashion Photos by Don Hay]

1975-76 Bronco football

The Boise State University Bronco football team began its quest for a third straight Big Sky football title Wednesday, August 20, when they reported back to the BSU campus.

Bronco head coach Tony Knap and his staff welcomed 84 hopefuls last Wednesday with a busy day which included meetings, the traditional Picture Day and team physicals.

The daily-double practice sessions began the next day, August 21, and continued through August 27. The Broncos had their two-a-

day sessions at 10 a.m. and 3:30 p.m. August 21 through August 26. The second session on August 27 will end at 8 p.m. in the stadium.

The drills will be cut to one evening session on August 28 and 29 due to registration and resume with two on August 30 and September 1. Classes at Boise State University will begin on Tuesday, September 2.

The opener for the Broncos will be in 20,000-seat Bronco Stadium when they host the Pioneers from Cal State Hayward on September 13 at 7:30 p.m.



The 1975-76 linebackers are, 38-Dave Fox, 39-Gary Gorrell, 58-Dave Williams, 55-Kaui Hookano, 37-Kirk Strauser, 32-Mike Romans, 51-Fill Van, 57-Greg Kadel, 66-Norm Cochrane, 35-John Boben, 47-Larry Polowski.



The 1975-76 offensive backs are (back to front), Dave Nicely, assistant defensive back coach, 30-Gene Skolick, 42-Ron Emery, 22-Mike Vandele, 34-Bob Cleveland, 27-Dan Blanc, 31-Mike Mallard, 28-Tom Simms, 36-Gary Russell, 40-John Smith, (second row) Chester Gray, student assistant, 2-Doug Knifong, 6-Fred Goode, 3-Kent Hollingsworth, 5-Rick Saunders, 26-Kirk Havlett, assistant coach Adam Rita.

Games room plans special

The Games Area and Outdoor Activities Center will be open during registration week. Everyone is invited in to see what we have to offer for your recreational needs while attending BSU. The Games Area is located on the first floor of the Student Union Building next to Your Campus Store. We have bowling lanes, billiard tables, table

tennis tables, foosball, pinball, and many check out games such as monopoly, chess, checkers, cards, kismet, stratego, etc.

The Games Area is open 7 days a week during posted hours. Monday, September 1, and Tuesday, September 2, will be 1/2 price days.

The Arbiter has an opening for a sports editor. Applicant must be able and willing to travel to games. Must have some knowledge of sports at BSU. Apply in the Arbiter office. This is a paid position.

Let Us Help You Capture The ACTION



Nikon Camera on Safelock Tripod.



Ballou-Latimer

SINCE 1869

CAMERA SHOP

One of Boise's Oldest Shops
Established 1869

COMPLETE PHOTOGRAPHIC EQUIPMENT



Quality Photo Finishing by Eastman Complete



Darkroom Headquarters



Eastman Kodak - Ilford Agfa - Luminous



Beseler - Durst - Omega Patterson



The Latest Color Chemistry



RENTALS & REPAIR

Zoom Lens Projectors - Tape Recorders

DOWNTOWN
828 W. Idaho
343-8541

Open
9:00 to 6:00 Daily

WESTGATE MALL
7830 Fairview Ave.
376-7312

10:00 to 9:00 Daily
Open Sunday

828 W. IDAHO
7830 FAIRVIEW AVE.

SUPER SAVER COUPON!

KODACOLOR FILM DEVELOPED & PRINTED



12 EXP. \$1.00

20 EXP. \$2.00

OFFER EXPIRES SEPTEMBER 11, 1975

SUPER SAVER COUPON!

KODACHROME OR EXTACHROME PROCESSING

SUPER 8, REGULAR 8mm \$1.19
OR 20 EXP. SLIDE FILM



36 EXP. \$2.19

OFFER EXPIRES SEPT. 11, 1975

If you're a backpacker...
or a climber...
or a hiker...
or a camper...
or a cross-country skier
We should know about you
And you should know about us

We have the finest brand name equipment: Sierra Designs, Kelly, Trailwise, Snowlion, Skilom, Fischer, Trak, Bonna, Rossignol...and others.

We are bonded, licensed, certified guides and instructors for backpacking, mountaineering, climbing and cross-country skiing.

We've told you what we do...

Come on in and tell us about you.

When you look to the mountains...look to the leaders.



5200 Fairview Ave. Boise, Idaho 83704 (208) 376-3731

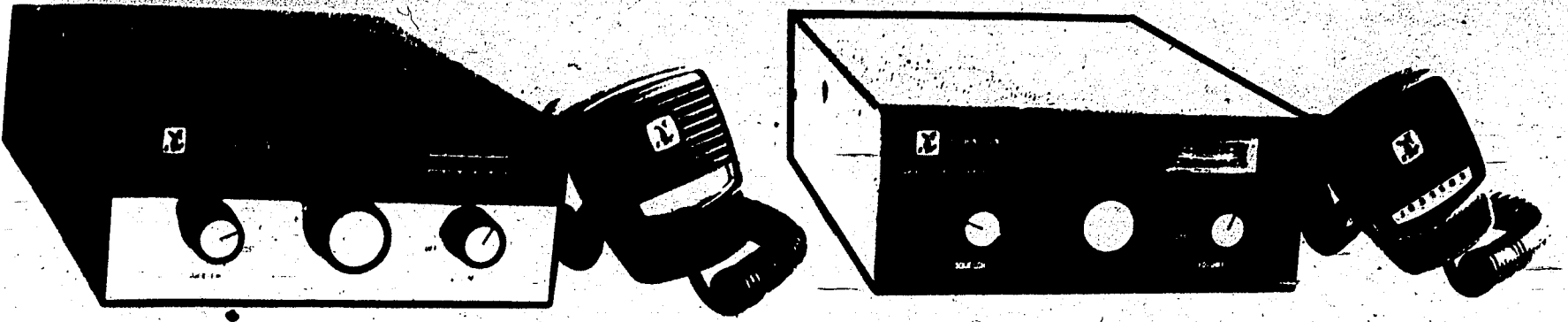

Shooting skip?

Citizen band radio catches on

by Bill Michels

Whip antennas, mobile stations, base stations, "handles", "shooting skip"—all play an intricate part in the fascinating hobby of citizen band radio which has been storming the country, as well as the Federal Communications Commission.

Citizen band radios, CB's, are by no means a new area of radio communication as their recent burst in popularity might indicate. In 1958 the FCC authorized the original 23 citizen band channels on an AM radio frequency of 26.965 megahertz to 27.225 megahertz, to "fulfill a need for reliable and inexpensive two way radio communication," according to Dale Peacock, owner of Banjo Electronics in Boise.

"It has not been until the last five years that CB's have really caught on," explained Peacock, and he estimates that there is a whopping eight million CB operators in the country at this time. Retail sales of CB's appear to be one of the best things that have hit the electronics market in a long time. Dave Levi, manager of Team Electronics in Boise, remarked that most of the factories were caught off guard by the tremendous consumer demand for CB's and long lists of customer back orders were not uncommon at retail outlets. Presently, supply has caught up to demand and most Boise stores have an adequate selection of sets.

Basically, two types of stations or radios are available to the potential CB enthusiast - the mobile and the base station. The mobile radio, by far the most popular, is easily mounted in a truck, car, boat or even on a motorcycle. The mobile provides one with a fast versatile means of communication while on the move. Transmitting and receiving ranges averages from eight to 15 miles, however, they can vary considerably depending on the terrain encountered and the type of antenna used.

Mobile sets come in a large assortment of sizes and shapes, from mini-sets with just the bare necessities to larger ones with PA (public address) attachments, external speakers and special 'delta' tuners to pull in a set which is broadcasting a little off frequency. Some mobiles, as well as base stations, have a single side band on them which splits the normal 23 channels into 69 channels and gives a much broader talking range. This single side band feature, unfortunately, is beyond the budget of most CB'ers and is therefore not found on the majority of the sets.

Manufacturers of mobile antennas provide a mind dazzling selection of equipment. Unlike antennas of years past, no drilling is required to install most models. One can simply pick a style that will attach to the bumper, to the gutter of the roof, to the groove in the trunk lid, or one that clips onto the outside mirrors. Length of mobile antennas varies from a nine foot whip, to an 18 inch "Mighty Mite," depending on individual preference.

Base stations are CB radios which are permanently mounted in a stationary place, such as one's home. Although usually bigger in appearance, the base station is no more powerful than the mobile both being legally restricted to four watts of output. Base stations are usually able to broadcast and receive farther than mobiles because they can be permanently located in favorable areas and can utilize bigger and more powerful antennas. Base station antennas must not be taller than 60 feet according to the FCC.

Antennas for base stations are numerous and varied, but they generally consist of two types - the omni-directional antenna and the directional antenna. The omni-directional antenna broadcasts and receives in a circle-like radius and allows the operator to listen and talk in all directions. The directional antenna, as the name implies, concentrates a narrow beam in a specific direction allowing greater capabilities in the

path that the beam follows, however blinds the operator to transmitting and receiving in other directions. Directional antennas are sometimes used for "shooting skip", which is skipping the radio beam hundreds of miles across the country enabling the operator to talk to other CBers in distant cities.

The FCC frowns on "shooting skip", as it is illegal to talk over a distance of 150 miles on a citizen band radio.

Licensing for the class D citizens band operator can mean a long wait. The FCC has been flooded by new CB applications, and the recent lowering of the fee from \$20 to four dollars helps matters.

"How 'bout that Purple Panty Hose Snatcher...you by?" The foregoing is an example of the colorful and somewhat challenging art of transmitting on a CB. The slang used on the air by CBers is a language all its own and requires some study to master. Some

examples of the unique slang include: Smokey - the name given to state troopers; Boulevard - the Interstate Highway; Barleypop - a cold beer. Just about every CB operator has a "handle" or a nickname in addition to his call letters (assigned by the FCC). Handles

are not taken lightly and much imagination and thought usually goes into them. As a result, one can actually register his or her handle in Idaho so that hopefully no duplication of handles occurs. A sampling of registered handles in Boise includes: The Shadow, Black Orchid, Blue Cobra, Magnum Force and Boilermaker.

Citizen band radios are not all fun and games. In the area of public service, CB radios and their operators have made many contribu-

tions. Untold emergencies are reported every day by observant CBers. Dispatcher Baker of the Boise City Police characterized the help the CBers render as "very good citizen interest" and cited their "willingness to get involved."

Channel nine on the citizen band radio is designated as an emergency channel by the FCC. In Boise the channel is monitored 24 hours a day by a volunteer organization appropriately called REACT. The

organization is designed to "provide a direct link between the public and the emergency agencies", according to Jay Sjurson, president of the local REACT chapter. Suppose a CBER is out in his mobile and spots an accident, he turns to channel nine and requests

a REACT member who he identifies himself to, and gives the details of the accident to the REACT member. The REACT member who has picked up the message via his base station, proceeds to call the appropriate emergency agencies by telephone, thus

initiating a possible lifesaving mission. Other public service organizations include I-80 Control, to assist motorists; and D and I Search and Rescue.

Citizen band radios have proven to be the "reliable and inexpensive" form of two way communication they were intended to be. In fact, they have gone far beyond this definition and have earned a distinct place in society...almost as if they were "as American as a CB radio".

WHEN IT COMES TO MUSIC COME TO BUDGET

AND HERES **5** GOOD REASONS WHY



**BACK TO SCHOOL
SPECIAL**

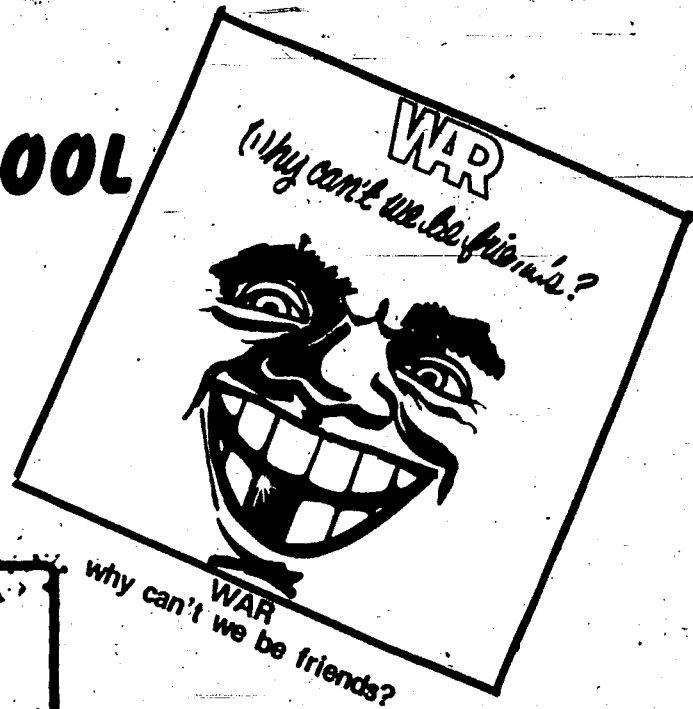

R. E. O. SPEEDWAGON
this time we mean it



EAGLES
one of these nights



OHIO PLAYERS

honey

for students with id

aug. 29-sept. 6

**records
\$3⁹⁹**

**tapes
\$5¹⁹**

WALK ACROSS CAMPUS AND SAVE!!!

BUDGET TAPES & RECORDS

on broadway across from bronco stadium